

Notes:
 Do not scale from this drawing.
 All contractors must visit the site and be responsible for taking and checking dimensions.
 All construction information should be taken from figured dimensions only.
 Any discrepancies between drawings, specifications and site conditions must be brought to the attention of the supervising officer.
 This drawing and the works depicted are the copyright of JTP.

This drawing is for planning purposes only. It is not intended to be used for construction purposes. Whilst all reasonable efforts are used to ensure drawings are accurate, JTP accept no responsibility or liability for any reliance placed on, or use made of, this plan by anyone for purposes other than those stated above.

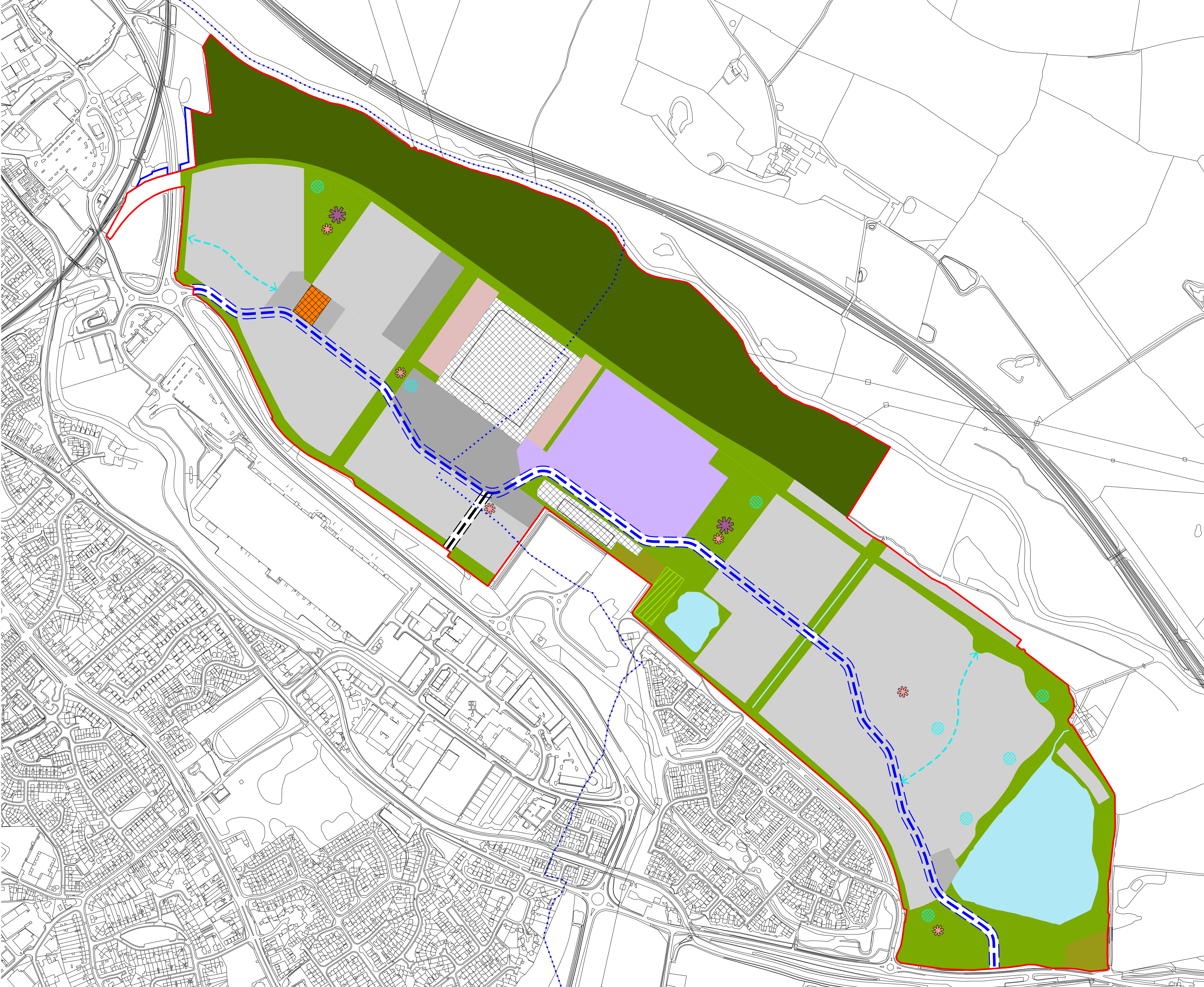

- Red Line - Application boundary
- Blue Line - Other Land in the Applicant's control
- Local Authority boundary
- Built development areas
- Existing sub-stations (including access roads)
- All Through School & shared playing fields or Primary School site and playing fields (D1)
- Other Formal Open Space
- Open Space (including water bodies, drainage features, footpaths/ cycleways, vegetation/ planted areas, play areas, retained trees, allotments/ community gardens and occasional vehicular connections)
- Natural Open Space (including informal open space, wildlife habitats, wetland areas, meadow land, wet woodlands, vegetation/ planted areas, retained trees, footpaths/ cycleways, play areas)
- Ground mounted solar panels
- Indicative location of community square
- Indicative location of LEAP
- Indicative location of NEAP
- Allotments
- Indicative location of surface attenuation ponds, basins and swales
- Primary road corridor (with +/- 30m limit of deviation from centre line along route shown)
- Shared pedestrian / cycle / vehicle corridor (with +/- 30m limit of deviation from centre line along route shown)

Note: The red line and associated area shown in this drawing are based on guidance provided by ENGIE. JTP accept no responsibility or liability for reliance placed on, or use made of, this plan by anyone for purposes other than planning.

Note: All features and areas are subject to a lateral tolerance of +/- 10m unless stated otherwise

Rev	Date	Description	Drawn	Chkd
P6	31.03.20	ATS, Key and LEAP location amended	AM	GP
P5	06.03.20	ATS Update	AM	GP
P4	01.10.19	Blue Line updated	VB	GP
P3	30.09.19	Blue Line updated	VB	GP
P2	27.08.19	Red Line updated	VB	GP
P1	13.09.19	First Issue	VB	GP

Drawing Status
PLANNING

Client
ENGIE

jtp JTP Studios
 Unit 5, The Rum Warehouse
 Pennington Street
 London, E1W 2AP
 +44 (0)20 7017 1780
 www.jtp.co.uk

Project
Rugeley Power Station

Drawing Title
**Green Infrastructure
 Parameter Plan**

Scale @ A2 1:5000 Job Ref. 01585
 Drawing No. 01585_PP_04 Revision P6
 Scale Bar 0 50 100 150m

